

## Construction

Single inlet direct driven centrifugal fan with rectangular formed casing of steel sheet, powder coated RAL5010.

Impeller with forward curved blades (type F) in galvanized steel sheet. V-belt driven fans can be supplied on request.

## Motor

220-240/380-420V, 50Hz (380-420/660-690V above 3kW) three-phase asynchronous motor. Enclosure IP55, insulation class F. Special voltage or frequency, insulation class, enclosure IP65, 2-speed motors and explosion proof motors can be supplied on request.

Wiring diagram, see page 179.

## Model numbering system

**G R F - 2 - 200/74 - 110 T**

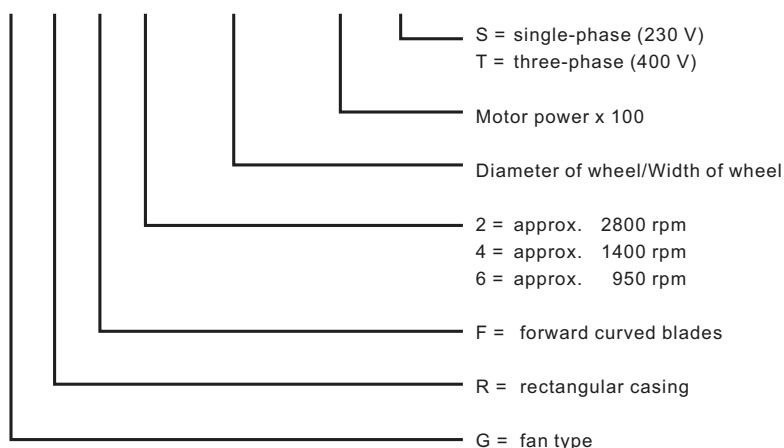

## Technical specification

Type	Motor power kW	Voltage V	Maximum current A	Maximum duty m <sup>3</sup> /h	Pressure (max) Pa	Sound level dB(A)	Weight kg	Article number
GRF-2-200/74-110T	1,10	230/400	4,3/2,5	1 800	1300	73	13	113 350 451
GRF-2-224/92-220T	2,20	230/400	8,0/4,6	2 850	1730	76	23	113 350 501
GRF-2-250/103-400T	4,00	400/690	7,8/4,5	4 300	2000	82	57	113 350 551
GRF-2-280/103-400T	4,00	400/690	7,8/4,5	4 000	2400	85	60	113 350 601
GRF-2-280/103-550T	5,50	400/690	10,0/6,5	4 400	2400	86	65	113 350 651
GRF-4-280/103-075T	0,75	230/400	3,3/1,9	2 700	700	79	19	113 351 001
GRF-4-280/103-075S	0,75	230	5,1	2 700	700	70	21	113 351 051
GRF-4-280/103-110T	1,10	230/400	4,6/2,7	3 800	700	71	22	113 351 061
GRF-4-315/143-220T	2,20	230/400	9,0/5,2	6 500	1000	72	36	113 351 101
GRF-4-400/183-400T	4,00	400/690	8,9/4,8	7 500	1470	82	78	113 351 151
GRF-4-400/183-550T	5,50	400/690	11,3/6,5	9 500	1470	82	88	113 351 161

## Accessories



Protection guard outlet



Connector outlet

Dimensions in mm

Type	A	B	C	D	E	F	G	H	I	J	K	L	M
GRF-2-200/74-110T	335	394	227	141	167	157	383	128	178	138	168	25	15
GRF-2-224/92-220T	335	394	227	141	187	178	451	148	198	138	168	25	15
GRF-2-250/103-400T	410	478	227	174	211	226	544	174	224	170	200	25	15
GRF-2-280/103-400T	410	470	262	180	250*	226	552	182	232	160	190	25	15
GRF-2-280/103-550T	410	470	262	180	250*	226	552	182	232	160	190	25	15
GRF-4-280/103-075T	410	470	262	180	250*	157	437	182	232	160	190	25	15
GRF-4-280/103-075S	410	470	262	180	250*	157	437	182	232	160	190	25	15
GRF-4-280/103-110T	410	470	262	180	250*	172	460	182	232	160	190	25	15
GRF-4-315/143-220T	500	596	354	211	265	198	575	228	278	246	276	25	15
GRF-4-400/183-400T	649	764	440	270	334	226	659	289	339	276	306	25	15
GRF-4-400/183-550T	649	764	440	270	334	226	686	289	339	276	306	25	15

\* - with inlet fitting

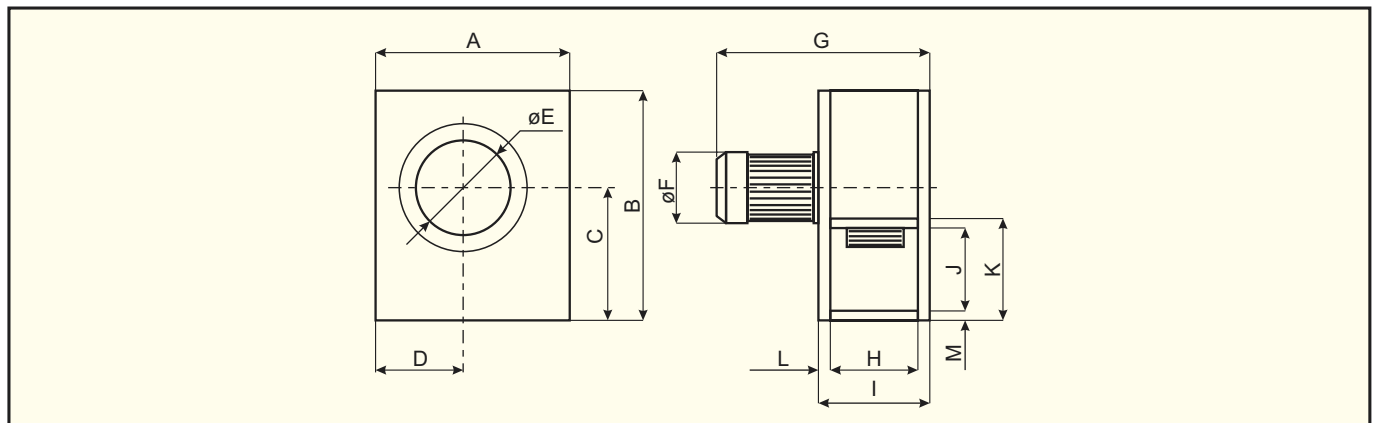

GRF-2

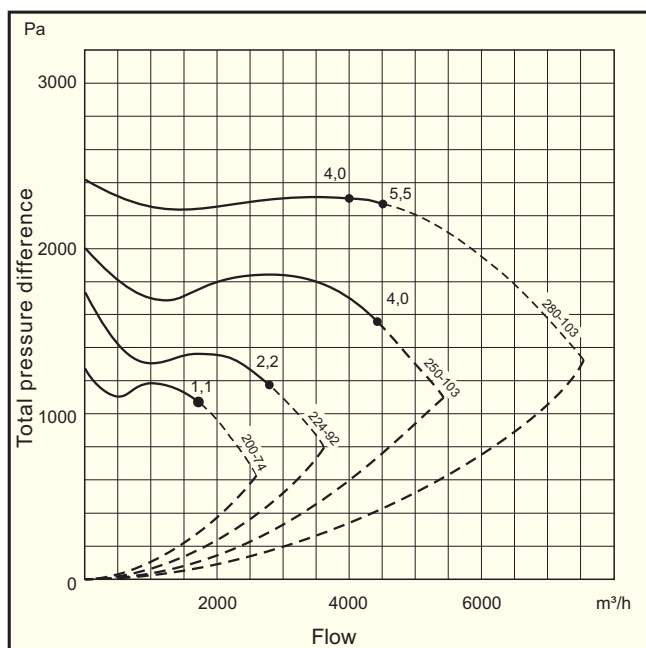

GRF-4

